

This is a general drawing. Additional parts, if required, like protection sheets, inspection covers, etc. are not displayed.

Designed constructed and stamped in accordance with 2010 ASME Code and latest Addendum.

PRESSURE PLATE
(MOVABLE)

SECTION A-A
PP = 0.79"

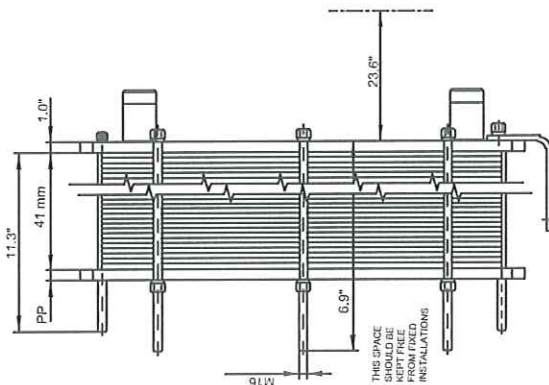
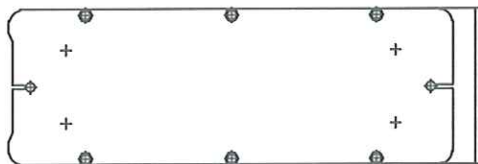

FRAME PLATE
(FIXED)

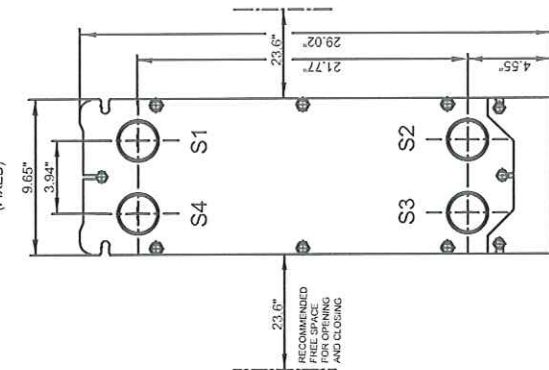

NPT
SS
S1, S2, S3, S4

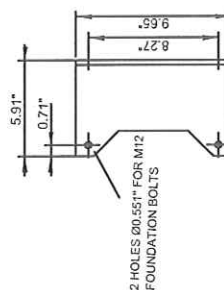
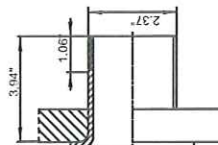

REMARKS:	SIDE 1	SIDE 2
DESIGN PRESSURE	150 psi	150 psi
TEST PRESSURE	195 psi	195 psi
MAX TEMPERATURE	302 °F	302 °F
MIN TEMPERATURE	32 °F	32 °F
MAWP	150 psi	150 psi
MDMT	-20 °F	

GASKET	EPDM CLIP-ON
PLATE MATERIAL	ALLOY 316
PLATE THICKNESS	0.50 mm
HEATING SURFACE	9 ft ²
PLATE GROUPING	1*5H/1*6H
WEIGHT WITH WATER	163 lb
NETWEIGHT	156 lb

108631

CERTIFIED
APPROVED FOR FABRICATION
BY CF DATE 07-13-2011

TOTAL LENGTH 15.3"
TOTAL WIDTH 9.7"
TOTAL HEIGHT 29"

REV.1: MARKED CERT.

ALL DIMENSIONS IN INCHES

SIDE	MEDIA	INLET	TEMP.	OUTLET	TEMP.	FLOW RATE	PRESSURE DROP	LIQUID VOL.
1	Water-Steam	S4	293.0 °F	S3	293.0 °F	795.7 lb/h	2.722 psi	0.06 ft ³
2	5.00% NaCl	S2	90.0 °F	S1	180.0 °F	8916 lb/h	4.153 psi	0.07 ft ³

SUPPLIER	REF. 43507-50	ITEM NO. HP-8202
AGENT / REF. / 774610		
CUSTOMER NAME / REF. NO. University Of Florida / 1100113912		
SIGN. CFN		RISK CATEGORY N/A

PLATE HEAT EXCHANGER

T5-MFG

ASME

SERIAL NUMBER 30113-89818	
DATE 2011-07-13	REV NO. 1

Alfa Laval, Plate Heat Exchanger
Channel Plate Installation Description

2011-07-13

Customer: University Of Florida SU Order No: 43507-50
 Model : T5-MFG Serial No: 30113-89818
 Customer PO: 1100113912 Item No: HP-8202

Plate material and Thickness: ALLOY 316 0.50 mm

A Dimension: 41 mm

	Hot side	Cold side
Grouping:	1*5H	1*6H
Sealing material:	EPDMP CLIP-ON	EPDMP CLIP-ON
Port Locations:	S4 -> S3	S2 -> S1

Connection material: Stainless steel Stainless steel

Port hole with flow on the gasketed side: U

Port hole sealed with O-ring: O

Plates are assembled with the gasket side facing the frame plate.

Plate no.	Plate code no.	Plate Pattern		Punched corner of the plate				Flow direction on the gasket side of the plate	
				upper left	lower left	lower right	upper right		
				S1	S2	S3	S4		
				=<=	=>=	=>=	=<=		
	FRAME PLATE								
1	39508736 83	T5 M2	A	O	O	O	O		
2	39508736 03	T5 M2	B	U	--<---	U	O	O	Up
3	39508736 03	T5 M2	A	O	O	U	--<---	U	Down
4	39508736 03	T5 M2	B	U	--<---	U	O	O	Up
5	39508736 03	T5 M2	A	O	O	U	--<---	U	Down
6	39508736 03	T5 M2	B	U	--<---	U	O	O	Up
7	39508736 03	T5 M2	A	O	O	U	--<---	U	Down
8	39508736 03	T5 M2	B	U	--<---	U	O	O	Up
9	39508736 03	T5 M2	A	O	O	U	--<---	U	Down
10	39508736 03	T5 M2	B	U	--<---	U	O	O	Up
11	39508736 03	T5 M2	A	O	O	U	--<---	U	Down
12	39508736 76	T5 M2	B		--<---				Up
	PRESSURE PLATE								
				T1	T2	T3	T4		

Article No:	Quantity:
39508736 83	1
39508736 03	10
39508736 76	1

CERTIFIED
 APPROVED FOR FABRICATION
 BY: CF DATE: 07-13-2011